



Rigid and Flexible Stranded Metric Conductor, One-Hole, Long Barrel Lug, No Window



For use with Class 2R Rigid Strand and Flexible Strand Class 5F and 6F Copper Conductors

Type LCMB

- Long barrel design to maximize number of crimps
- No inspection window to prevent contaminants from entering barrel
- Tin-plated to inhibit corrosion
- UL Listed and CSA Certified to 35 kV** and temperature rated to 90°C when crimped with Panduit® tools and dies
- Approved for Marine use by American Bureau of Shipping
- Class 2r, Class 5f and Class 6f wire sizes and stud hole size marked on connector for selection and installation
- Rounded tongue for use in tight spaces
- Internally beveled wire entry for fast and easy installation
- Meets EN61238-1:2003/IEC 61238-1-2003 Class B for 4mm²-240mm² Class 2r wire sizes
- CE compliant sizes 10mm²-240mm² Class 2r wire sizes

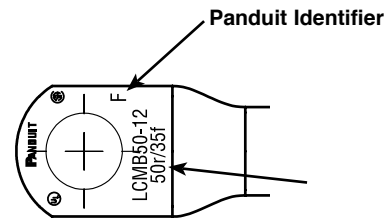
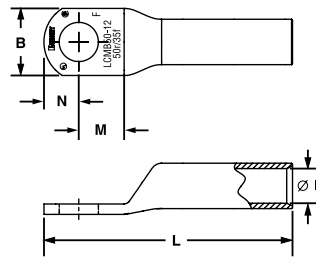

Rigid and Flexible Stranded Conductor Sizes Marked on Part

Part Number	Copper Conductor Size Class 2r (mm ²)	Copper Conductor Size class 5f/6f ^A (mm ²)	Stud Hole Size (mm)	Figure Dimensions					Std. Pkg. Qty.
				ØI	B	M	N	L	
LCMB10-5-L	10	—	M5	4.5	11	9.8	6	43.8	50
LCMB10-6-L	10	—	M6	4.5	11	9.8	6	43.8	50
LCMB10-8-L	10	—	M8	4.5	13	8.5	8	43.8	50
LCMB10-10-L	10	—	M10	4.4	14.5	8.5	8	43.8	50
LCMB16-5-L	16	10	M5	5.5	13	10.3	6.5	47.2	50
LCMB16-6-L	16	10	M6	5.5	13	10.3	6.5	47.2	50
LCMB16-8-L	16	10	M8	5.5	13	10.3	6.5	47.2	50
LCMB16-10-L	16	10	M10	5.5	15	10.2	8	49.4	50
LCMB25-6-L	25	16	M6	6.9	14	10	8	48.7	50
LCMB25-8-L	25	16	M8	6.9	15.5	10	8	48.7	50
LCMB25-10-L	25	16	M10	6.9	15.5	10	8	48.7	50
LCMB35-6-Q	35	25	M6	8.2	15.5	12.3	8.5	57.3	25
LCMB35-8-Q	35	25	M8	8.2	15.5	12.3	8.5	57.3	25
LCMB35-10-Q	35	25	M10	8.2	15.5	12.3	8.5	57.3	25
LCMB35-12-Q	35	25	M12	8.2	21.5	14.5	11.5	63.3	25
LCMB50-6-E	50	35	M6	9.8	18	11.5	10	62.8	20
LCMB50-8-E	50	35	M8	9.8	18	11.5	10	62.8	20
LCMB50-10-E	50	35	M10	9.8	18	11.5	10	62.8	20
LCMB50-12-E	50	35	M12	9.8	23	14	11	66.3	20
LCMB70-8-X	70	50	M8	11.5	20.8	14.5	11.5	68.2	10
LCMB70-10-X	70	50	M10	11.5	20.8	14.5	11.5	68.2	10
LCMB70-12-X	70	50	M12	11.5	20.8	14.5	11.5	68.2	10

Visit www.panduit.com/tools for tool and die information.

^AClass 5f conductor only.

**Consult cable manufacturer for voltage stress relief instructions with applications greater than 2000 V.

^ANot CE compliant and not tested to EN 61238-1:2003/IEC 61238-1:2003 for terminations with metric Class 5f or Class 6f flexible stranded conductor.



Rigid and Flexible Stranded Metric Conductor, One-Hole, Long Barrel Lug, No Window (continued)

Part Number	Copper Conductor Size Class 2r (mm ²)	Copper Conductor Size class 5f/6f [^] (mm ²)	Stud Hole Size (mm)	Figure Dimensions					Std. Pkg. Qty.
				ØI	B	M	N	L	
LCMB95-8-X	95	70	M8	13.5	24.5	15	13.5	79	10
LCMB95-10-X	95	70	M10	13.5	24.5	15	13.5	79	10
LCMB95-12-X	95	70	M12	13.5	24.5	15	13.5	79	10
LCMB95-16-X	95	70	M16	13.5	24.5	15	13.5	79	10
LCMB120-8-X	120	95	M8	15.2	27.5	15.5	14.5	80.2	10
LCMB120-10-X	120	95	M10	15.2	27.5	15.5	14.5	80.2	10
LCMB120-12-X	120	95	M12	15.2	27.5	15.5	14.5	80.2	10
LCMB120-16-X	120	95	M16	15.2	27.5	15.5	14.5	80.2	10
LCMB150-8-X	150	120	M8	16.5	30.5	18	16.5	100	10
LCMB150-10-X	150	120	M10	16.5	30.5	18	16.5	100	10
LCMB150-12-X	150	120	M12	16.5	30.5	18	16.5	100	10
LCMB150-16-X	150	120	M16	16.5	30.5	18	16.5	100	10
LCMB150-20-X	150	120	M20	16.5	30.5	22	16.5	103.5	10
LCMB185-10-X	185	150	M10	18.6	33.5	16.5	17.5	100.6	10
LCMB185-12-X	185	150	M12	18.6	33.5	16.5	17.5	100.6	10
LCMB185-16-X	185	150	M16	18.6	33.5	16.5	17.5	100.6	10
LCMB185-20-X	185	150	M20	18.6	33.5	21	17.5	105.1	10
LCMB240-10-6	240	185	M10	20.8	37.5	21	19.5	115	6
LCMB240-12-6	240	185	M12	20.8	37.5	21	19.5	115	6
LCMB240-16-6	240	185	M16	20.8	37.5	21	19.5	115	6
LCMB240-20-6	240	185	M20	20.8	37.5	21	19.5	115	6
LCMB300-10-6	300	240	M10	23.5	42.5	22	20	122.6	6
LCMB300-12-6	300	240	M12	23.5	42.5	22	20	122.6	6
LCMB300-16-6	300	240	M16	23.5	42.5	22	20	122.6	6
LCMB300-20-6	300	240	M20	23.5	42.5	22	20	122.6	6
LCMBX300-10-6 [^]	—	300 [*]	M10	26.2	48	26.5	23.5	135.2	6
LCMBX300-12-6 [^]	—	300 [*]	M12	26.2	48	26.5	23.5	135.2	6
LCMBX300-16-6 [^]	—	300 [*]	M16	26.2	48	26.5	23.5	135.2	6
LCMBX300-20-6 [^]	—	300 [*]	M20	26.2	48	26.5	23.5	135.2	6
LCMB400-12-6	400	—	M12	27	49.5	26.5	23.5	127.4	6
LCMB400-16-6	400	—	M16	27	49.5	26.5	23.5	127.4	6
LCMB400-20-6	400	—	M20	27	49.5	26.5	23.5	127.4	6
LCMB500-12-3	500	—	M12	31	57.5	28.5	25.5	149.7	3
LCMB500-16-3	500	—	M16	31	57.5	28.5	25.5	149.7	3
LCMB500-20-3	500	—	M20	31	57.5	28.5	25.5	149.7	3
LCMB630-16-3	630	—	M16	34.5	63	28.5	27.5	159.1	3
LCMB630-20-3	630	—	M20	34.5	63	28.5	27.5	159.1	3

Visit www.panduit.com/tools for tool and die information.

^{*}Class 5f conductor only.

^{**}Consult cable manufacturer for voltage stress relief instructions with applications greater than 2000 V.

[^]Not CE compliant and not tested to EN 61238-2:2003/IEC 61238-1:2003 for terminations with metric Class 5f or Class 6f flexible stranded conductor.